

[www.fishman.com](http://www.fishman.com)

***FISHMAN***

**USER GUIDE  
PRO-EQ PLATINUM**

## Quick Start

1. Place XLR Pre/Post switch to "post" position.
2. Adjust the Input Gain so that the Clip/Low Battery light barely flickers with strong playing.
3. Strum hard and raise the Smooth knob up until you hear the Compressor take the percussive edge off your highs.
4. Set Phase switch to position that sounds best and suppresses feedback.
5. Set the Notch dial between 1:00 and 2:30 to suppress low end feedback.

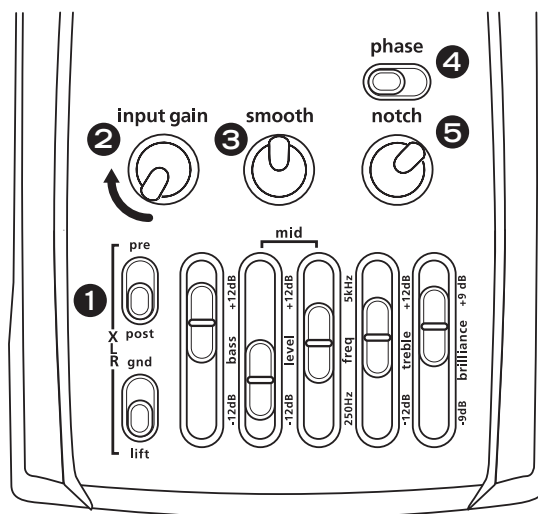

# Power Options

---

## 1. 9 Volt battery

Squeeze the tabs on top of the preamp together and the battery drawer will pop out. Snap in a fresh 9 Volt alkaline. To conserve the battery, unplug the input of the Pro-EQ Platinum when you are not using the preamp.

## 2. 48 Volt phantom power

Use an XLR cable to connect the Pro-EQ Platinum to a mixing board with 48V phantom power. When you turn on the 48V phantom at the mixer, the green 48V phantom LED lights up, the 9V battery shuts off and the Pro-EQ Platinum draws power through the XLR cable.

The green 48V phantom LED may not light up once you switch on phantom power. This means the phantom power from the mixer is not delivering enough voltage. For insurance, keep a fresh 9V battery in the preamp. The battery will take up the slack if the phantom power is too low.

## 3. AC adapter input

Use only a well filtered and regulated AC adapter with a 9 Volt DC output. We recommend the Fishman 910-R. Use of a non-recommended adapter may void the warranty and damage the unit.

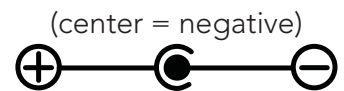

## **Input—Plug Your Instrument In Here**

---

When you plug into the input jack, the 9 Volt battery switches on. Remember to unplug the input jack when you are not using the preamp to save the battery. Turn down your amp or mute your mixer input before you plug into the Pro-EQ Platinum input to protect your speakers (and your ears) from loud pops.

## **Input Gain**

---

For the cleanest possible signal, adjust the Input Gain so that the Clip/Low Battery LED barely flickers with strong playing. If the Clip LED lights up brightly as you play, your instrument signal is overdriving the circuit and you will hear distortion. Not every instrument will have enough signal to engage the Clip light on your Platinum. This is perfectly acceptable.

## Clip/Low Battery Indicator

---

This light has three distinct functions:

### 1. Power up indicator

The LED flashes briefly when you plug into the input—it is telling you that the unit is powering up.

### 2. Clip indicator

Flashes brightly when your instrument signal overloads the preamp. Adjust the Input Gain so that the Clip LED barely flashes with strong playing.

### 3. Low battery warning

When the red LED lights with no signal present it is time to change the battery. If the Low Battery light comes on while you're playing, don't worry, you'll have enough power to get through a gig (at least 4 hours).

## Volume

---

For the cleanest sound, set the Volume as high as you can without distorting your amp or mixer.

## Smooth Acoustic Compression

---

Takes the percussive edge off of your high end when you play hard.

To set the Smooth control:

1. Turn the Smooth knob fully counter-clockwise.
2. Adjust the Input Gain so that the Clip / Low Battery light faintly flashes when you play your hardest.
3. Raise the Smooth knob (clockwise) just enough to take the percussive edge off your string sound as you strum hard (set the dial at about 12:00). Be aware that turning the Smooth knob up too high may kill the highs for lighter picking styles.

## Notch and Phase

---

These controls work to suppress two adjacent ranges of acoustic feedback. We use guitar as an example, but the Notch filter and Phase switch are compatible with all acoustic instruments.

**The Notch control** is a variable frequency notch filter designed to subdue a resonant peak on the instrument which is prone to feedback. Turning the knob adjusts the center frequency of the filter, ranging from subsonic (off) to 330Hz at full clockwise.

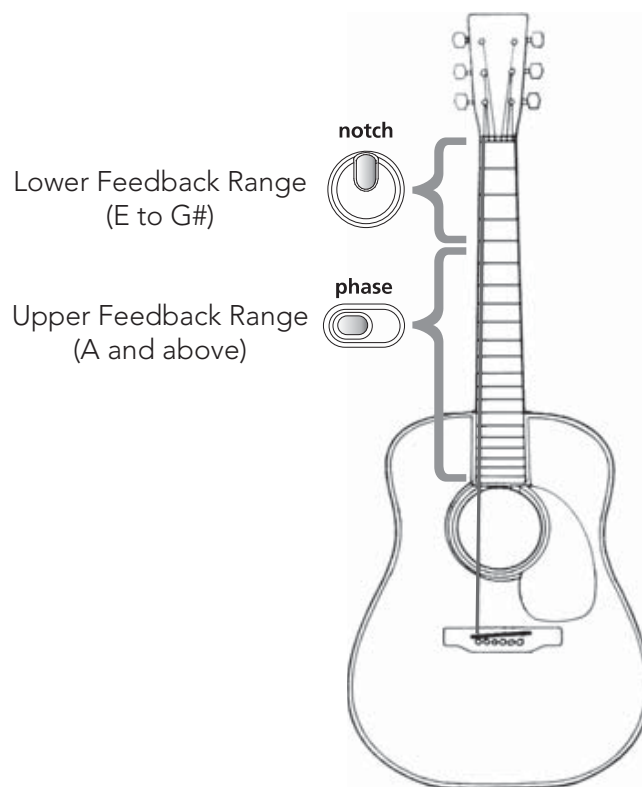

When not being used for feedback, the Notch control can also be used as a tone control to subdue an unpleasant frequency in a microphone or room. Play a note which accentuates the offending frequency and turn the control until the intensity is diminished.

**The Phase switch** flips the polarity of your instrument signal from positive to negative, changing its relationship to the sound coming from the amplifier. One phase setting usually provides better resistance to feedback than the other and will vary depending on the instrument and playing environment. Another approach to determining optimal phase is the selection which sounds or feels most natural when playing.

In certain playing environments the Phase switch may not have an audible impact.

## Tone Controls

---

**Bass:** A boost here will add depth and weight to the sound of an instrument with light bass response. Cut the bass a few dB to tighten up the big boomy tone of a dreadnought or jumbo guitar.

**Mid EQ:** Two sliders (Level and Frequency) make up the Mid control. The Frequency slider lets you tune in on a specific mid-frequency range which you can boost or cut with the Level slider.

**Treble:** A boost here will help to “cut through the mix.” Conversely, cutting the Treble will mellow and subdue your amplified tone.

**Brilliance:** This slider can add shimmer and sparkle to your sound or reduce excessive finger noise and fret buzz.

## Output (1/4" Unbalanced)

---

Signal Path: Instrument signal ⇒ Input Gain ⇒ Depth ⇒ EQ ⇒ Compression ⇒ Volume ⇒ Phase Switch ⇒ Output

Plug a standard instrument cable from the Platinum output to your amplifier or unbalanced mixer input.

## XLR (Balanced) Out

---

Plug a standard mic cable from the XLR out into a PA or recording console.

Note that the Platinum can be powered by a 48V phantom supply through this output. (See Power Options on page 4)

# XLR Pre/Post Switch

---

Choose between a true D.I. (pre EQ) or an affected XLR output (post EQ).

## 1. XLR Post

Signal Path: Instrument Signal ⇒ Input Gain ⇒ Depth ⇒ EQ ⇒ Compression ⇒ Volume ⇒ Phase Switch ⇒ XLR Out

Post is useful in live venues (especially if you are mixing from onstage) where you want your personal “dialed-in” sound to come through the PA.

## 2. XLR Pre

Signal Path: Instrument Signal ⇒ Input Buffer ⇒ Phase Switch ⇒ XLR Out

You’ll find that this true direct or “DI” output produces a warm and uncluttered signal that is exceptional for recording. Set the Pre/Post switch to the Pre position when you want a “flat” DI signal going to the board and you wish to leave it to the sound-person or recording engineer to dial up the instrument tone from the console.

## XLR Ground Lift

---

Use this switch to eliminate AC ground loop hum. When you use the XLR and one of the other outputs together and you hear hum from the speakers, put the switch in the "lift" position and the hum should go away. If you use all three outputs (XLR, 1/4" output and tuner/send) to three separate AC powered devices, the "lift" position may not completely eliminate ground loop hum.

Note: When you use only the XLR out, leave the Gnd/Lift switch in the "gnd" position. In these cases, if you move the switch to the "lift" position, you will hear a "pop" through your speakers and phantom power to the unit may be compromised.

## Tuner/Send

---

Signal Path: Instrument Signal ⇒ Input Buffer ⇒ Tuner/Send

Use the tuner/send output when you need an unbalanced direct signal that is not affected by any of the front panel controls. Use it for an external tuner or as an aux send to a stage amp or a second mixer for broadcast/live recording.

# Sample EQ Settings

## Fingerstyle

This setting will add fullness to the bass and definition to the treble.

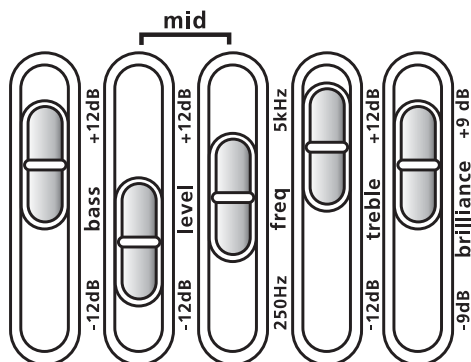

Fingerstyle

## Mid cut

To scoop out harsh midrange.

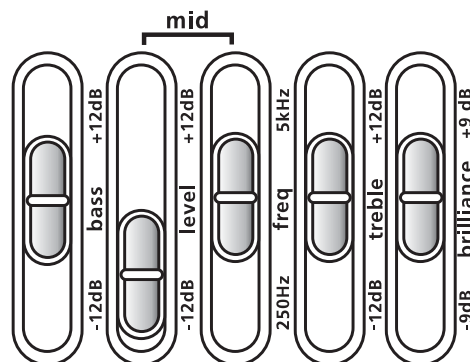

Mid Cut

## Strummer

This is a good overall setting if you mainly strum the instrument.

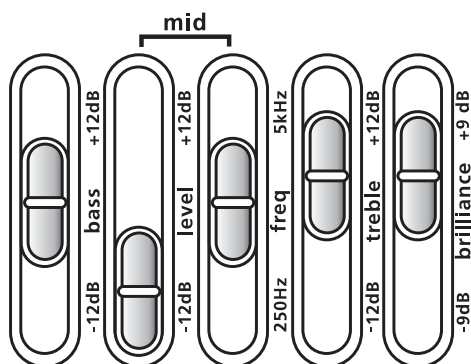

Strummer

## Cut through the mix

This setting is helpful when you need to be heard through a loud band.

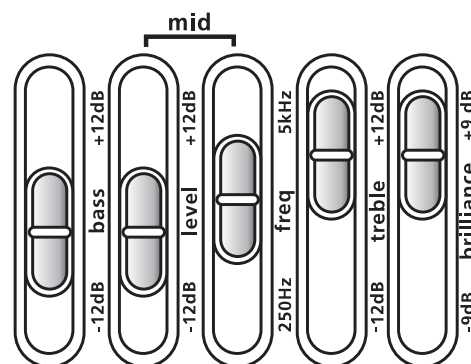

Cut Through

# Stage Setup

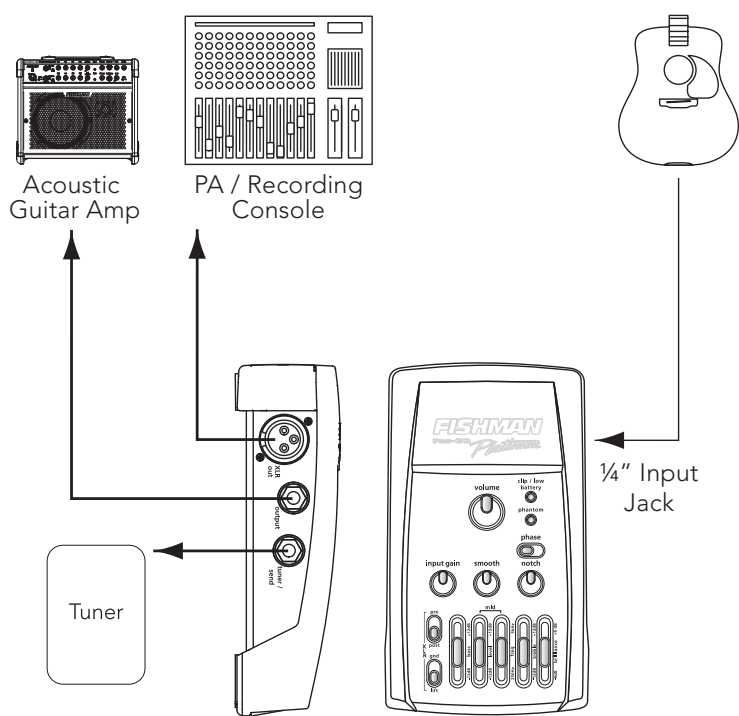

# Block Diagram

Note: This diagram is meant only to describe the signal routing for the Pro-EQ Platinum and does not represent the actual electronic layout of the preamp.

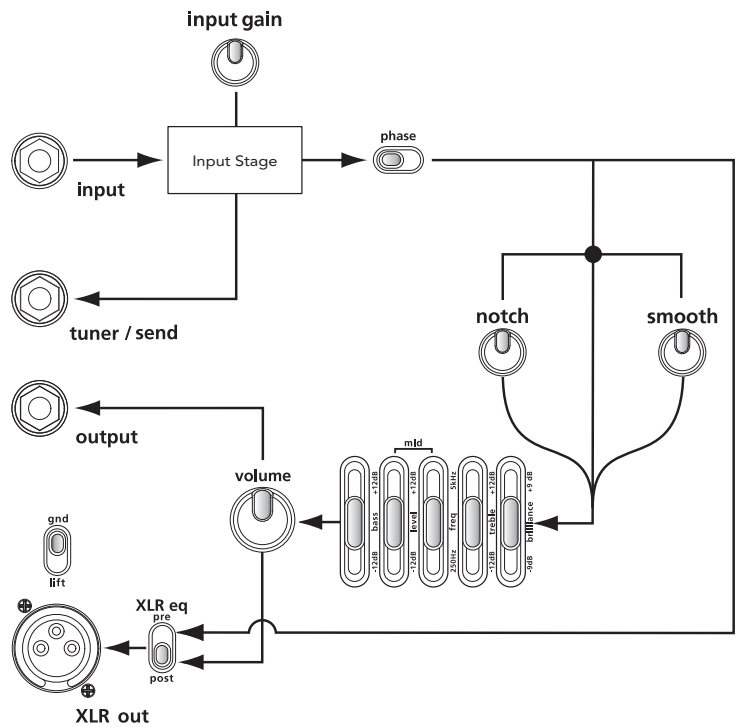

## Specifications

---

Nominal Input Level: -20dBV  
Input Overload Level: +6dBV  
Input Impedance: 10MW

### **Nominal output levels and impedances**

¼" Out: -23dBV + 3dBV (1kW)  
Tuner/Send Out: -23dBV + 3dBV(1kW)  
XLR Out: -32dBV -6dBV (600W )  
Bass Control Range: ±12dB at 60Hz  
±3dB at 350Hz  
Treble Control Range: ±12dB at 10kHz  
±3dB at 2.4kHz  
Mid Control Range: ±12dB (adjustable from  
250Hz to 5kHz) Q=0.5  
Brilliance Control Range: ±9dB at 10kHz  
±3dB bandwidth 7kHz

THD:	Less than .02%, -10dBV input
Signal to Noise Ratio:	90dB (A weighted, -10dBV input, 2dBV ¼" output)
Power Supply:	9V alkaline battery (estimated 120 hours continuous use) Regulated FISHMAN 9V AC adapter
Current Draw:	4.7mA

All specifications subject to change without notice.